

For Commercial Applications

Job Name _____

Contractor _____

Job Location _____

Approval _____

Engineer _____

Contractor's P.O. No. _____

Approval _____

Representative _____

Tag _____

BFD-440-SO

Sanitary Floor Drain With 12" Round Top, Side Outlet

Specification

BLÜCHER BFD-440-SO AISI Type 304 stainless steel sanitary floor drain with 12"(300) round top, 1/8"(3) grating (standard), and side outlet.



BFD-440-SO

Dimensions

Model No.	Global Part #	Pipe Size D	H1	W1
BFD-444-SO	726.503.110	4"(110)	6 15/16"(176)	8 1/8"(206)
BFD-446-SO	726.503.160	6"(160)	6 5/16"(160)	13 7/16"(341)

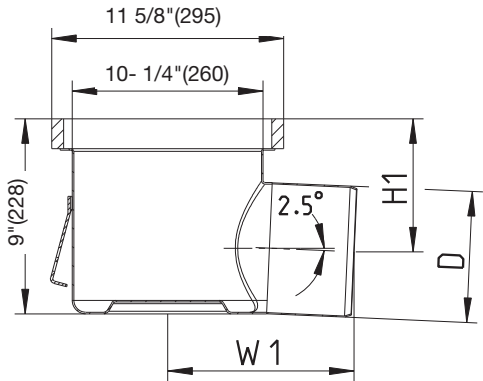

Optional Gratings			
	Suffix	Description	
	-None	1/8" (Standard)	<input type="checkbox"/>
	-LG	Ladder	<input type="checkbox"/>
	-MG	Mesh	<input type="checkbox"/>
	-SG	Slot	<input type="checkbox"/>

Suffix	Options (Select One Or More) Description	
-150	1/2 Grate (Standard Grating)	<input type="checkbox"/>
-175	3/4 Grate (Standard Grating)	<input type="checkbox"/>
-316	Type 316 Stainless Steel	<input type="checkbox"/>
-B	Sediment Basket	<input type="checkbox"/>
-P	Stainless Steel P-Trap	<input type="checkbox"/>
-SB	Sand Bucket	<input type="checkbox"/>
-TPT	Trap Primer Tapping	<input type="checkbox"/>
-VP	Grate Secured w/Vandal Proof Screws	<input type="checkbox"/>

NOTICE

The information contained herein is not intended to replace the full product installation and safety information available or the experience of a trained product installer. You are required to thoroughly read all installation instructions and product safety information before beginning the installation of this product.

Approvals



Compliance with NSF/ANSI/3-A 14159-1-Hygiene Requirements for the Design of Meat and Poultry Processing Equipment



A **WATTS Brand**